

⚠ WARNING

This equipment should not be installed, operated or maintained by any person who has not read and understood all the contents of this manual. Failure to read and comply with the contents of this manual can result in serious bodily injury or death, and/or property damage. Record the hoist code, lot and serial number in the space provided below.

Product Code:

Lot Number:

Serial Number:

Table of Contents

1.0	IMPORTANT INFORMATION AND WARNINGS.....	1
2.0	TECHNICAL INFORMATION.....	2
3.0	OPERATION.....	2
4.0	INSPECTION.....	3
5.0	MAINTENANCE.....	5
6.0	WARRANTY.....	6
7.0	PARTS LIST.....	6

1.0 Important Information and Warnings

1.1 Terms and Summary

This manual provides important information for personnel involved with the installation, operation and maintenance of this product. Although you may be familiar with this or similar equipment, it is strongly recommended that you read this manual before installing, operating or maintaining the product.

Danger, Warning, Caution and Notice – Throughout this manual there are steps and procedures that can present hazardous situations. The following signal words are used to identify the degree or level of hazard seriousness.

⚠ DANGER

Danger indicates an imminently hazardous situation which, if not avoided, **will** result in **death or serious injury**, and property damage.

⚠ WARNING

Warning indicates an imminently hazardous situation which, if not avoided, **could** result in **death or serious injury**, and property damage.

⚠ CAUTION

Caution indicates a potentially hazardous situation which, if not avoided, **may** result **minor or moderate injury** or property damage.

NOTICE

Notice is used to notify people of installation, operation, or maintenance information which is important but not directly hazard-related.

The operation of a hoist involves more than activating the hoist's controls. Per the ANSI/ASME B30 standards, the use of a hoist is subject to certain hazards that cannot be mitigated by engineered features, but only by the exercise of intelligence, care, common sense, and experience in anticipating the effects and results of activating the hoist's controls. Use this guidance in conjunction with other warnings, cautions, and notices in this manual to govern the operation and use of your hoist.

1.2 Shall's and Shall Not's for Operation

⚠ WARNING

Improper operation of a hoist can create a potentially hazardous situation which, if not avoided, could result in **death** or **serious injury**, and substantial property damage. To avoid such a potentially hazardous situation **THE OPERATOR SHALL:**

- **NOT** use hoist before reading Owner's Manual.
- **NOT** lift more than rated load for the hoist.
- **NOT** operate hoist when it is restricted from forming a straight line from hook to hook in the direction of loading.
- **NOT** use hoist with twisted, kinked, damaged, or worn chain.
- **NOT** use damaged hoist or hoist that is not working properly.
- **NOT** use the hoist to lift, support, or transport people.
- **NOT** lift loads over people.
- **NOT** use hoist with extension on lever handle.
- **NOT** remove or obscure the warnings on the hoist.
- **NOT** use load chain as a sling or wrap load chain around load.
- **NOT** use in a way that causes either hook to be side loaded.
- **NOT** apply the load to the tip of the hook or to the hook latch.
- **NOT** use hoist if hook latch is missing or malfunctioning.
- **NOT** apply load unless load chain is properly seated in the load sheave.
- **NOT** use the hoist in such a way that could result in shock or impact loads being applied to the hoist.
- **NOT** attempt to lengthen the load chain or repair damaged load chain.
- **NOT** operate beyond the limits of the load chain travel.
- **NOT** operate hoist with missing/damaged chain stopper.
- **NOT** leave load supported by the hoist unattended unless specific precautions have been taken.
- **NOT** allow the chain, or hook to be used as an electrical or welding ground.
- **NOT** allow the chain, or hook to be touched by a live welding electrode.
- **NOT** operate a hoist on which the safety placards or decals are missing or illegible.
- Be familiar with operating controls, procedures, and warnings.
- Make sure the unit is securely attached to a suitable support before applying load.
- Make sure load slings or other approved single attachments are properly sized, rigged, and seated in the hook saddle.
- Take up slack carefully - make sure load is balanced and load-holding action is secure before continuing.
- Make sure all persons stay clear of the supported load.
- Protect the hoist's load chain from weld splatter or other damaging contaminants.
- Report Malfunctions or unusual performances (including unusual noises) of the hoist and remove the hoist from service until the malfunction or unusual performance is resolved.
- Warn personnel before lifting or moving a load.
- Warn personnel of an approaching load.

6.0 Warranty

All products sold by Harrington Hoists, Inc. are warranted to be free from defects in material and workmanship from date of shipment by Harrington for the following periods:

- 1 year – Electric and Air Powered Hoists (excluding (N)ER2 Enhanced Features Models), Powered Trolleys, Powered Tiger Track Jibs and Gantries, Crane Components, Sling Chain, Spare / Replacement Parts
- 2 years – Manual Hoists & Trolleys, Beam Clamps
- 3 years – (N)ER2 Enhanced Features Model Hoists
- 5 years – Manual Tiger Track Jibs and Gantries, TNER Pull - Rotor Motor Brake
- 10 years – (N)ER2 "The Guardian" Smart Brake

The product must be used in accordance with manufacturer's recommendations and must not have been subject to abuse, lack of maintenance, misuse, negligence, or unauthorized repairs or alterations.

Should any defect in material or workmanship occur during the above time period in any product, as determined by Harrington Hoist's inspection of the product, Harrington Hoists, Inc. agrees, at its discretion, either to replace (not including installation) or repair the part or product free of charge and deliver said item F.O.B. Harrington Hoists, Inc. place of business to customer.

Customer must obtain a Return Goods Authorization as directed by Harrington or Harrington's published repair center prior to shipping product for warranty evaluation. An explanation of the complaint must accompany the product. Product must be returned freight prepaid. Upon repair, the product will be covered for the remainder of the original warranty period. Replacement parts installed after the original warranty period will only be eligible for replacement (not including installation) for a period of one year from the installation date. If it is determined there is no defect, or that the defect resulted from causes not within the scope of Harrington's warranty, the customer will be responsible for the costs of returning the product.

Harrington Hoists, Inc. disclaims any and all other warranties of any kind expressed or implied as to the product's merchantability or fitness for a particular application. Harrington will not be liable for death, injuries to persons or property or for incidental, contingent, special or consequential damages, loss or expense arising in connection with the use or inability whatever, regardless of whether damage, loss or expense results from any act or failure to act by Harrington, whether negligent or willful, or from any other reason.

7.0 Parts List

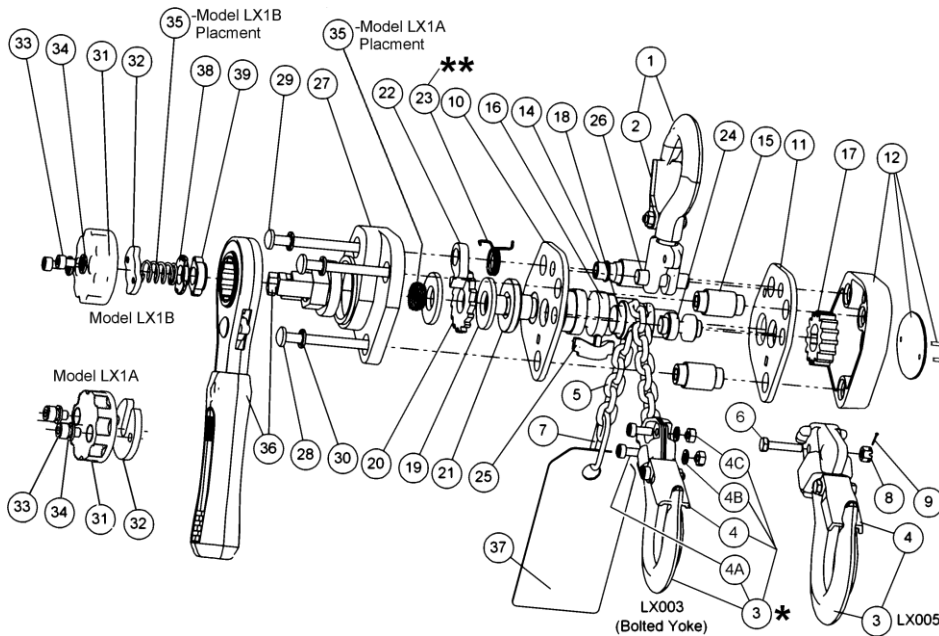

* LX003 Bottom Hook:

- Refer to section 2.2.2 For technical information.
- Fastener Assembly:
 - Torque to 40 – 48 lb_f - in.
 - Use Loctite® Threadlocker 241 or 242.

** Pawl Spring Assembly = 2 springs.

Figure No.	Part Name	Model	Parts Per Hoist	LX003 1/4 Ton	LX005 1/2 Ton
1	Top Hook Assembly		1	L1XA0031001	L1XA0051001
2	Latch Assembly		1	L1XA0031071	L1XA0051071
3 *	Bottom Hook Assembly		1	L1XA0031021	L1XA0051021
4	Latch Assembly		1	L1XA0031071	L1XA0051071
4a	Spring Washer		2	9012707	
4b	Hex Nut		2	9093414	
4c	Socket Head Cap Screw		2	9091203	
5	Load Chain		FT	LCLX003NP	LCLX005NP
6	Chain Pin		1		L1LA0059041
7	Chain Stopper Link		1	L1XA0039045	L1LA0059045
8	Slotted Nut		1		L1LA0059049
9	Split Pin		1		9009401
10	Frame A		1	L1XA0039101	L1XA0059101
11	Frame B		1	L1XA0039102	L1XA0059102
12	Gear Case with Nameplate		1	L1XA0035103	L1XA0055103
14	Stud A		2	L1XA0039104	L1XA0059104
15	Stud B		1	L1XA0039105	L1XA0059105
16	Pinion	LX1A	1	L1XA0039111	L1XA0059111
		LX1B	1	L1XA0039111R3	L1XA0059111R2
17	Load Gear		1	L1XA0039114	L1XA0059114
18	Load Sheave		1	L1XA0039116	L1XA0059116
19	Friction Plate		2	L1XA0039151	L1XA0059151
20	Ratchet Disc		1	L1XA0039152	L1XA0059152
21	Friction Disc		1	L1XA0039153	L1XA0059153

Figure No.	Part Name	Model	Parts Per Hoist	LX003 1/4 Ton	LX005 1/2 Ton
22	Pawl		1		L1XA0039155
23	Pawl Spring Assembly **		1		L1XA0039158
24	Guide Roller		1	L1XA0039161	L1XA0059161
25	Stripper		1	L1XA0039162	L1XA0059162
26	Top Pin		1	L1XA0039163	L1XA0059163
27	Brake Cover		1	L1XA0039172	L1XA0059172
28	Button Head Socket Screw		2	L1XA0039173	L1XA0039174
29	Button Head Socket Screw		1	L1XA0039174	L1XA0059174
30	Internal Tooth Lock Washer		3		96797J09
31	Chain Knob	LX1A	1	L1XA0039201R1	L1XA0059201R1
		LX1B	1		L1XA0039201R2
32	Lever Clamping Plate	LX1A	1	L1XA0039202R1	L1XA0059202R1
		LX1B	1	L1XA0039202R2	L1XA0059202R2
33	Socket Bolt	LX1A	2	9091224	9091225
		LX1B	1		9091201
34	Conical Lock Washer	LX1A	2		L1XA0039204R1
		LX1B	1		L1XA0039204R2
35	Free Chain Spring	LX1A	1	L1XA0039205	L1XA0059205
		LX1B	1		L1XA0039205R3
36	Lever Assembly	LX1A	1	L1XA0034211	L1XA0054211
		LX1B	1	L1XA0034211R2	L1XA0054211R2
37	Warning Tag		1		WTAG9
38	Free Chain Plate	LX1B	1		L1XA0039209
39	Cam Guide	LX1B	1		L1XA0039203

Harrington Hoists, Inc.
401 West End Avenue
Manheim, PA 17545
Phone: 717-665-2000
Toll Free: 800-233-3010
Fax: 717-665-2861



www.harringtonhoists.com

Harrington Hoists - Western Division
2341 Pomona Rincon Rd. #103
Corona, CA 91720
Phone: 951-279-7100
Toll Free: 800-317-7111
Fax: 951-279-7500

LXOM